

High-Capacity Cable Crimper

Operating Instructions Manual

27-798

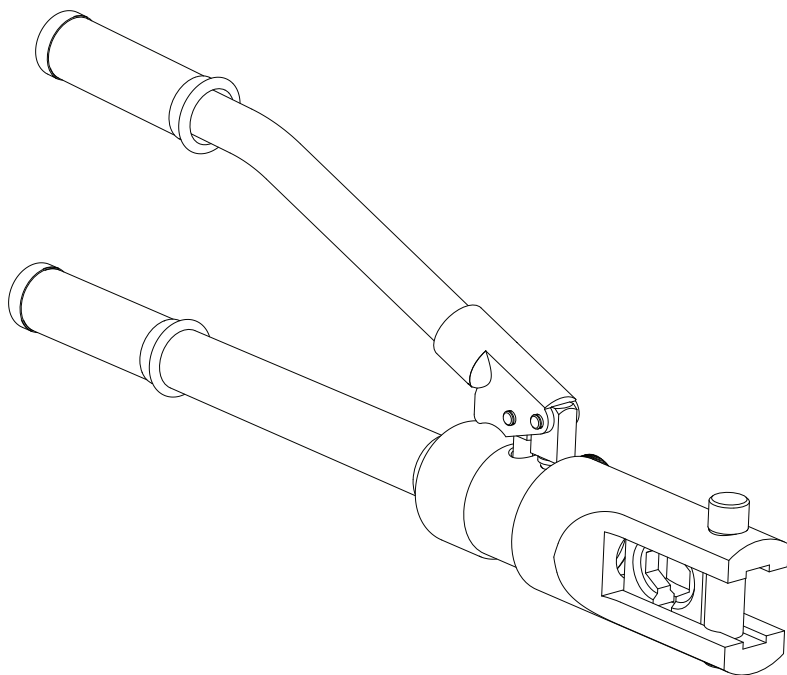

Read through this Operating Instructions Manual carefully before using the product. Protect yourself and others by observing all safety information, warnings, and cautions. Failure to comply with instructions could result in personal injury and/or damage to product or property. Please retain instructions for future reference.

READ BEFORE USING

It is the owner and/or operator's responsibility to study all warnings, operating and maintenance instructions contained on the product label and in the instruction manual prior to use of this product. The owner/operator should retain product instructions for future reference.

The owner and/or operator are responsible for maintaining all decals or warning labels while in use, maintaining the unit in good working order and performing all general maintenance of the product. If the owner and/or operator are not fluent in English, the product warnings and instructions shall be read and discussed with the operator's native language by the purchaser/owner or his designee. Make sure that the operator comprehends its contents. Safety information shall be emphasized and understood prior to usage. The product shall be inspected per the operating instructions. Users of this product must fully understand these instructions. Each person using this product must also be of sound mind and body and must not be under the influence of any substance that might impair their vision, dexterity or judgment.

Protect yourself and others by observing all safety information.

Failure to comply with instructions could result in personal injury and/or property damage.

Record Product's Serial Number Here: _____

Note: If product has no serial number, record month and year of purchase instead.

NOTICE





This manual is intended for your benefit. Please read and follow the safety, maintenance and troubleshooting steps described within to ensure your safety and satisfaction. The contents of this instruction manual are based upon the latest product information available at the time of publication. The manufacturer reserves the right to make product changes at any time without notice.

IMPORTANT SAFETY INSTRUCTIONS

Help protect yourself and others from injury - read, follow, and save these important safety precautions and operating instructions.

Read and understand all instructions. Failure to follow these safety precautions and operating instructions could result in severe personal injury, property damage or death.

WARNING SYMBOLS AND DEFINITIONS

	This is the safety alert symbol. It is used to alert you to potential personal injury hazards. Obey all safety messages that follow this symbol to avoid possible injury or death.
 DANGER	Indicates a hazardous situation which, if not avoided, will result in death or serious injury.
 WARNING	Indicates a hazardous situation which, if not avoided, could result in death or serious injury.
 CAUTION	Indicates a hazardous situation which, if not avoided, could result in minor or moderate injury.
NOTICE CAUTION	Addresses practices not related to personal injury.

IMPORTANT SAFETY INSTRUCTIONS

WARNING

READ ALL SAFETY WARNINGS AND ALL INSTRUCTIONS.

Failure to follow the warnings and instructions may result in electric shock, fire and/or serious injury.

PERSONAL SAFETY

1. **Stay alert, watch what you are doing and use common sense when operating this tool. Do not use a tool while you are tired or under the influence of drugs, alcohol or medication.** A moment of inattention while operating tools may result in serious personal injury.
2. **Use personal protective equipment. Always wear eye protection.** Protective equipment such as dust mask, non-skid safety shoes, hard hat, or hearing protection used for appropriate conditions will reduce personal injuries.
3. **Do not overreach. Keep proper footing and balance at all times.**
4. **Dress properly. Do not wear loose clothing or jewelry. Keep your hair, clothing and gloves away from moving parts.** Loose clothes, jewelry or long hair can be caught in moving parts.
5. **Do not force the tool, use the right tools for your application.**
6. **Store idle tools out of the reach of children and untrained users.**
7. **Maintain hydraulic crimper;** check for misalignment or binding of moving parts, breakage of parts and other conditions that may affect the hydraulic tool's operation. If damaged, please have the hydraulic tool repaired before further use. Many accidents are caused by poorly maintained tools.
8. Use the hydraulic crimping tools and accessories in accordance with these instructions and in the manner intended, taking into account that operations different from those intended could result in a hazardous situation.

ELECTRICAL SAFETY

DANGER

Switch off breaker to power source whenever working on connected electrical wiring.

DANGER

An incomplete crimp can cause a fire.

- Use proper connector and cable combinations. Improper combinations can result in an incomplete crimp.
 - The handle load will drop suddenly to indicate a completed crimp. If the handle load does not drop suddenly, the crimp is not complete.
- Failure to observe these warnings could result in severe injury or death.

SPECIFICATIONS & COMPONENTS

Crimping range:	Copper: AWG #6-4/0 (10-120 mm ²)
Crimping force:	15,736 Lbf (70kN)
Crimping type:	Hexagon crimping
Crimping stroke:	0.55 in (14 mm)
Oil type:	ISO 15 Hydraulic mineral oil
Oil storage Capacity:	Approximately 1.69 oz (50 ml)
Dimensions:	16.3 in x 2.68 in x 4.72 in (414 x 68 x 120 mm)
Standard dies:	AWG# 6, 4, 2-1, 1/0, 2/0, 3/0, 4/0 (16, 25, 35, 50, 70, 95, 120 mm ²)

SPECIFICATIONS & COMPONENTS

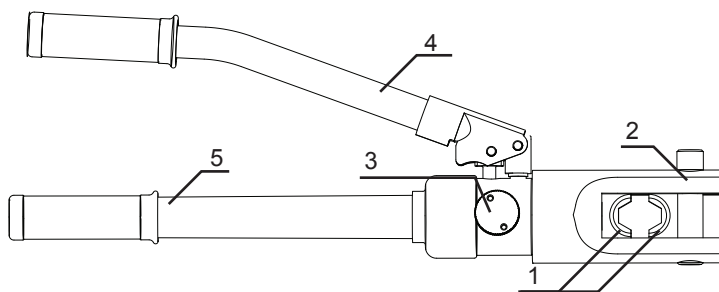

Number	Name	Remark
1	Die	For crimping, interchangeable crimping die
2	Crimper Head	For holding dies
3	Thumb wheel	For retaining and releasing oil pressure
4	Active handle	For operating
5	Fixed handle	For storing oil

OPERATING INSTRUCTIONS

⚠ WARNING

READ ALL SAFETY WARNINGS AND ALL INSTRUCTIONS.

Failure to follow the warnings and instructions may result in electric shock, fire and/or serious injury.

Select the appropriate die set. It is recommended to consult a qualified professional for proper compression die set for the connector, copper tube sleeve end and cable being used.

⚠ CAUTION

DO NOT operate crimper without dies completely set into crimper head.

1. Remove the latch pin from the tool head. (Fig 1)
2. Insert the lower die into the groove of the tool head. (Fig 2)
3. Put the cable into the tool head. (Fig 3)
4. Insert the upper die into the groove of the tool head.
5. Insert the latch pin into the tool head, ensuring it is fully seated.
6. Fully insert the stripped cable end into the barrel of the connector. (Fig 4)
7. Place the connector between the dies.
8. Make sure both die halves are secured before operating the tool to compress the connector.
9. Rotate the thumb wheel in the clockwise direction to close the valve.
10. With the connector and cable properly positioned between the dies, pump the handle to compress the connector.
11. Rotate the thumb wheel in the counter-clockwise direction to open the valve and retract the piston.
12. Remove the completed workpiece. If necessary, remove the latch pin from the tool head to remove finished cable.

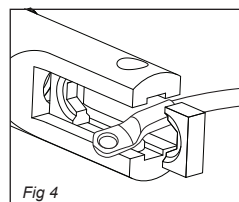
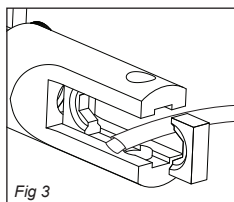
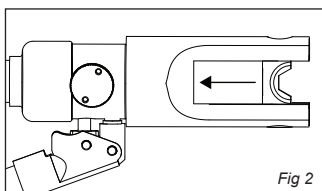
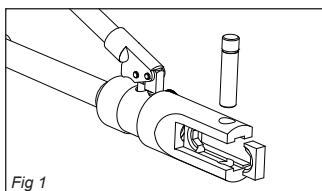

The tool is ready for the next cycle.

OPERATING INSTRUCTIONS

AWG	Cast Copper Battery Terminals and Lugs	Copper Tube Lugs
	Recommended Die (mm ²)	Recommended Die (mm ²)
6	35	16
4	35	25
1-2	50	35
1/0	70	50
2/0	70	50
3/0	95	95
4/0	120	120

Crimp Quality Diagram

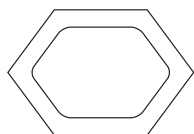

Best

Corners should be as crisp and sharp as possible.

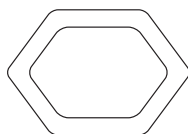

Acceptable

Corner radius should be shorter than the length of the flat sides.

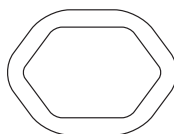

Too Loose

Die size is too large. Select a smaller die.

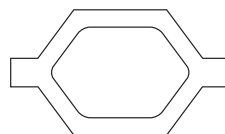

Over-Crimped

Die size is too small. Select a larger die.

OPERATING INSTRUCTIONS

HOW TO CHANGE THE OIL

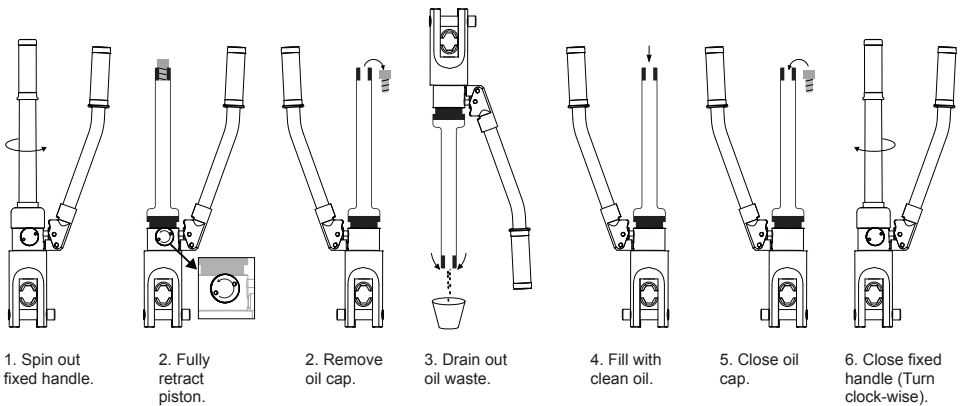

⚠ WARNING

Dust or air inside the tool will damage the sealing kit and cause the oil to leak. Make sure the oil is clear of debris when changing oil. Wait for a while and exhaust the oil completely out of the oil tube before inserting the oil plug.

⚠ WARNING

Please wear rubber gloves to avoid skin touching the oil directly. Please wash hands with soapy water after handling oil. Properly dispose of waste oil according to local regulations.

MAINTENANCE AND SERVICE



Damaged equipment may cause injury.

1. **Inspect hydraulic crimper before operating.** Check for loose screws, misalignment or binding of moving parts, cracked or broken parts, or any other condition that may affect its safe operation.
2. **Tool care and storage.** Clean external surface of the tools with clean towel. Apply rust preventing oil on the metal surface of the machine and the dies to avoid rust. Store the tool in a dry environment.
3. **Service requires a qualified service technician.**
4. **In order to prolong the tool's working life, please change the oil regularly.** Take care to avoid dust and debris in the oil reservoir.
5. Always store tool with the piston in the retracted position.
6. The original seals may fail after many uses. If leaks develop replace the sealing rings.

TROUBLESHOOTING

PROBLEM	POSSIBLE CAUSE	LIKELY SOLUTION
P1. No pressure or the pressure is not enough during operating.	1. The pump lacks enough oil. 2. There is dust in oil. 3. Internal leakage.	1. Fill with oil. 2. Change the oil. 3. Contact manufacturer or distributor.
P2. The lug and wire do not connect tightly after crimping work.	1. The tool can not achieve the rated pressure. 2. Use of wrong die set.	1. Refer to the fault P1. 2. Replace with the right die set. 3. Consult a qualified professional.
P3. Generates a lot of burs after crimping work.	1. Use of wrong die set.	1. Replace with the right die set. 2. Consult a qualified professional.
P4. Oil leakage on the head or ram.	1. O-ring(s) deteriorated.	1. Replace deteriorated O-ring(s) 2. Have serviced by qualified professional.

PARTS LIST

No.	Description	Qty
1	Die	1
2	Bolt	1
3	Spring	1
4	Pin	1
5	Latch	1
6	Head	1
7	Spring	1
8	Piston	1
9	Plastic retainer ring	1
10	O-Ring	1
11	Steel ball	1
12	Steel ball	1
13	Spring	1
14	Valve	1
15	Post	1
16	Copper gasket	1
17	Bolt	1
18	O-Ring	1
19	Plastic retainer ring	1
20	Plunger	1
21	Pin	1
22	Retainer ring	1
23	Active handle	1
24	Handle sleeve	1
25	Bolt	1
26	Screw	1
27	O-Ring	1
28	Plunger	1
29	Steel ball	1
30	Pin	1
31	Cylinder	1
32	Valve	1
33	Spring	1
34	Steel ball	1
35	Filter	1
36	Filter sleeve	1
37	Plastic retainer ring	1
38	O-Ring	1
39	Oil tube	1
40	Plug	1
41	Fixed handle	1
42	Handle sleeve	1

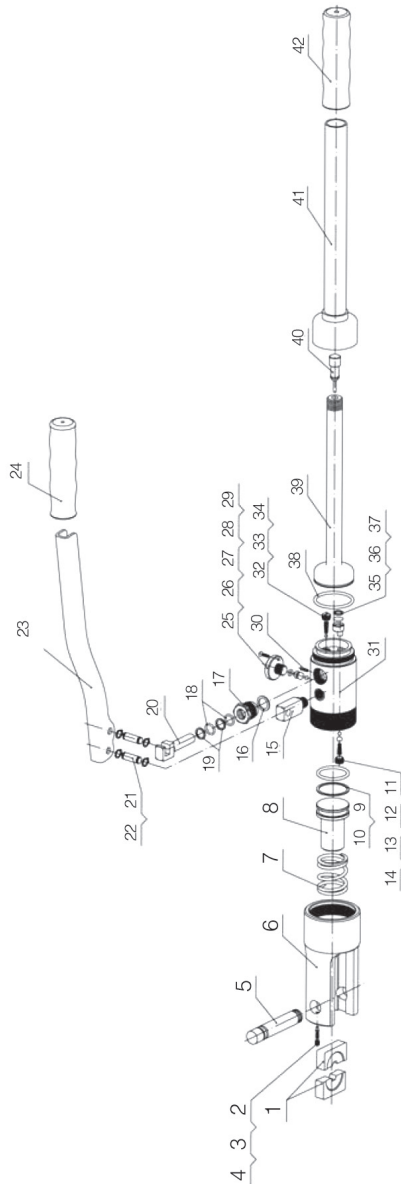

NOTES

NOTES

LIMITED WARRANTY

Kimball Midwest warrants to the original buyer ("Buyer") all parts and accessories purchased by it from Kimball Midwest against defects in material or workmanship.

Kimball Midwest will repair or replace, at no charge to the buyer, this tool which, after examination by Kimball Midwest, is determined to be defective within a period of 30 days from receipt.

Coverage under this warranty will be provided only if the defective tool has been submitted to Kimball Midwest for inspection.

This warranty does not cover any damage to this tool due to alteration, modification, improper installation, accident, post-installation misuse, abuse, negligence, inadequate maintenance, or malfunction of associated parts or equipment not supplied by Kimball Midwest.

This warranty is in lieu of any other warranty, expressed or implied, including any warranty of merchantability or fitness for a particular purpose. Replacement or repair as provided under this warranty is the exclusive remedy of the buyer. Kimball Midwest shall not be liable for any incidental or consequential damages resulting from breach of this warranty. Kimball Midwest neither assumes, nor authorizes any person to assume for it, any other liability in connection with the sale of its products.

If this Kimball Midwest Product proves defective in material or workmanship within 30 days after purchase, contact the Kimball Midwest Quality Assurance Department at All-QualityAssurance@kimballmidwest.com